

BM20 da 1 a 6 leve

BM20 from 1 to 6 levers

Caratteristiche generali / Technical characteristics		
	l/min	GPM
• Portata nominale / Nominal flow	17	4,5
• Portata limite / Max flow	25	6,6
	bar	PSI
• Pressione nominale / Nominal pressure	250	3600
• Pressione max sugli utilizzi / Max pressure on ports	320	4700
• Contropressione max allo scarico / Max pressure in tank-line	80	1100



P-T - TEMPERATURA OLIO 50°C - VISCOSITÀ 3,5°E

P-A/B - TEMPERATURA OLIO 50°C - VISCOSITÀ 3,5°E

A/B-T - TEMPERATURA OLIO 50°C - VISCOSITÀ 3,5°E

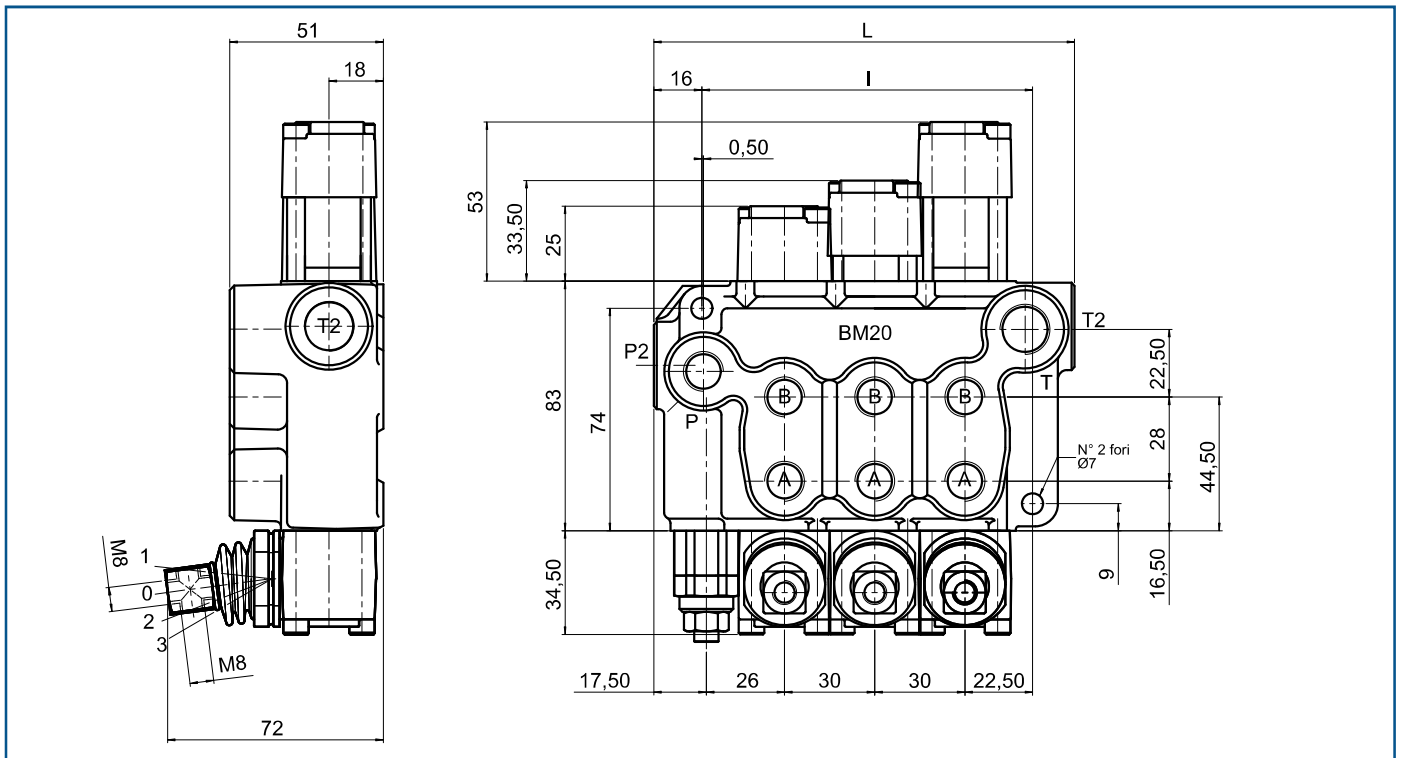
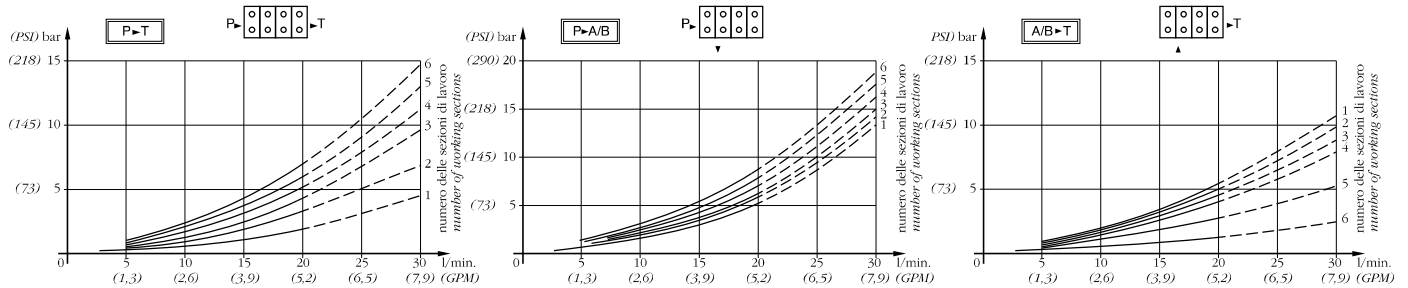

MOD	L	I	Kg
BM20/1	76	50	1,5
BM20/2	106	80	2,3
BM20/3	136	110	3,1
BM20/4	166	140	3,9
BM20/5	196	170	4,7
BM20/6	226	200	5,5

FILETTATURA STANDARD - STANDARD THREADS

COD	A-B	P	T	P ₂	T ₂
G	1/4"	1/4"	3/8"	3/8"	3/8"
F	9/16" - 18	9/16" - 18	9/16" - 18	3/4" - 16	3/4" - 16

◀ Su richiesta filettature diverse
Other threads available on request

